

BLOCKS- MILLER HI-LIFT BLOCKS

Wide capacity range available

- Standard capacities to 300T
- Design factor 4:1
- Larger capacities available
- Sheaves from 8" to 36"
- Wire rope sizes to 1 3/4"

Hooks- high quality forged alloy steel

- Per DIN 15401 or DIN 15402
- Other hook standards available
- Heavy duty thrust bearing
- Dual motion- swing plus 360° rotation
- Safety latch on all hooks
- Double and other hooks available

Heavy welded steel plate construction

- provides rigidity and strength for longer life
- Designed for shortest possible overall length
- Enclosed sheave guard for easier threading- eliminates possibility of rope jumping sheave
- "H" models provide additional overhaul weight with detachable steel cheek plates
- "T" and "TF", extended or standard side plates- on 24" sheave models

Bearings and sheaves

- For sheave sizes 20" and below, hardened and ground sheave pin with roller bearings
- For sheaves 24" and higher, tapered roller bearings with lip seals on alloy steel sheave pin
- Bronze bushings optional
- Individual sheave lubrication for assured grease penetration.
- Heavy duty cast steel sheaves standard, roll formed/welded sheaves available
- Bronze spacers between sheaves eliminate galling

Options available

- Double hooks
- Higher load capacities
- Fittings other than hook
- Hook rotation locking device
- Third party certifications
- Cast hooks (quad)
- Custom

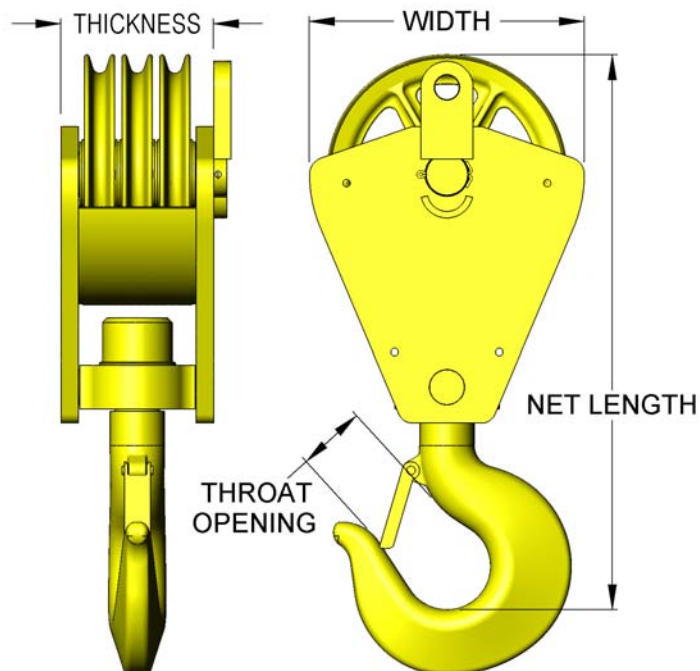

BLOCKS- MILLER HI-LIFT BLOCKS

MILLER Block Model Number Key				
# # # (Number of Sheaves)	(Sheave Outside Diameter (in))*	XX (Configuration)**	- # # # - (Working load limit)***	XX (Special Designation)****
<p>*Standard Outside Diameter Sheave Range from 8 to 36"</p> <p>**Block Configuration Options:</p> <p>F - Roller Bearing Mounted Sheaves, Low Profile Side Plates</p> <p>H - Roller Bearing Mounted Sheaves, Low Profile Side Plates, Cheek weights</p> <p>TF - Tapered Roller Bearing Mounted Sheaves, Low Profile Side Plates</p> <p>T - Tapered Roller Bearing Mounted Sheaves, Extended Side Plates</p> <p>***Working Load Limit Range from 5 to 300T</p> <p>****Special Designations:</p> <p>RT - Round Top Side Plates</p> <p>LD - Locking Device, 4 Positions</p>				
****Specify Wire Rope Size When Ordering****				

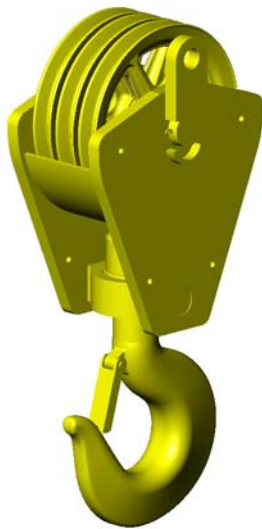

MODEL NO: 314F30
 -3 SHEAVES, 14" DIAMETER
 -LOW PROFILE SIDE PLATES
 -30 TON WLL



MODEL NO: 520H80
 -5 SHEAVES, 20" DIAMETER
 -CHEEK WEIGHTS
 -80 TON WLL



MODEL NO: 224T50
 -2 SHEAVES, 24" DIAMETER
 -EXTENDED SIDE PLATES
 -50 TON WLL



BLOCKS- MILLER HI-LIFT BLOCKS

5 TON

WLL* Tons	Model Number	SHEAVE DIA. (in.)	# OF SHEAVES	THICKNESS (in.)	WIDTH (in.)	NET LENGTH (in.)	THROAT OPENING (in.)	SHEAVE PIN DIA. (in.)	STD WIRE ROPE DIA. (in.)	Weight Lbs.
5	108F5	8	1	5.75	9.5	17.50	1.88	1.63	7/16	70
5	108H5	8	1	8.75	9.5	17.50	1.88	1.63	7/16	120
5	110F5	10	1	9.5	11.5	19.00	1.88	1.63	9/16	90
5	110H5	10	1	13	11.5	19.00	1.88	1.63	9/16	160
5	112F5	12	1	7.5	13.5	22.50	1.88	2.50	5/8	140
5	112H5	12	1	10.5	13.5	22.50	1.88	2.50	5/8	240
5	114F5	14	1	7.5	15.5	27.06	1.88	2.50	3/4	160
5	114H5	14	1	11	15.5	27.06	1.88	2.50	3/4	320
5	208F5	8	2	5.75	9.5	19.75	1.88	1.63	7/16	80
5	208H5	8	2	8.75	9.5	19.75	1.88	1.63	7/16	130

10 TON

WLL* Tons	Model Number	SHEAVE DIA. (in.)	# OF SHEAVES	THICKNESS (in.)	WIDTH (in.)	NET LENGTH (in.)	THROAT OPENING (in.)	SHEAVE PIN DIA. (in.)	STD WIRE ROPE DIA. (in.)	Weight Lbs.
10	108F10	8	1	5.75	9.5	19.75	2.50	1.63	7/16	80
10	108H10	8	1	8.75	9.5	19.75	2.50	1.63	7/16	130
10	110F10	10	1	6	11.5	22.00	2.50	1.63	9/16	100
10	110H10	10	1	9.5	11.5	22.00	2.50	1.63	9/16	170
10	112F10	12	1	7.5	13.5	24.75	2.50	2.50	5/8	150
10	112H10	12	1	10.5	13.5	24.75	2.50	2.50	5/8	250
10	114F10	14	1	7.5	15.5	27.75	2.50	2.50	3/4	170
10	114H10	14	1	11	15.5	27.75	2.50	2.50	3/4	330
10	116F10	16	1	8.75	17.5	30.56	2.50	3.00	7/8	250
10	116H10	16	1	13.75	17.5	30.56	2.50	3.00	7/8	490
10	118F10	18	1	8.75	19.5	32.75	2.50	3.00	7/8	285
10	118H10	18	1	12.75	19.5	32.75	2.50	3.00	7/8	585
10	208F10	8	2	5.75	9.5	19.75	2.50	1.63	7/16	85
10	208H10	8	2	8.75	9.5	19.75	2.50	1.63	7/16	135
10	210F10	10	2	6	11.5	22.00	2.50	1.63	9/16	110
10	210H10	10	2	9.5	11.5	22.00	2.50	1.63	9/16	180
10	212F10	12	2	7.5	13.5	24.75	2.50	2.50	5/8	165
10	212H10	12	2	10.5	13.5	24.75	2.50	2.50	5/8	265
10	214F10	14	2	7.5	15.5	28.00	2.50	2.50	3/4	215
10	214H10	14	2	11	15.5	28.00	2.50	2.50	3/4	365
10	308F10	8	3	7.25	9.5	19.75	2.50	1.63	7/16	95
10	308H10	8	3	10.25	9.5	19.75	2.50	1.63	7/16	145
10	310F10	10	3	7.5	11.5	22.00	2.50	1.63	9/16	125
10	310H10	10	3	11	11.5	22.00	2.50	1.63	9/16	195
10	312F10	12	3	9.75	13.5	24.75	2.50	2.50	5/8	210
10	312H10	12	3	12.75	13.5	24.75	2.50	2.50	5/8	310



BLOCKS- MILLER HI-LIFT BLOCKS

15 TON

WLL* Tons	Model Number	SHEAVE DIA. (in.)	# OF SHEAVES	THICKNESS (in.)	WIDTH (in.)	NET LENGTH (in.)	THROAT OPENING (in.)	SHEAVE PIN DIA. (in.)	STD WIRE ROPE DIA. (in.)	Weight Lbs.
15	114F15	14	1	7.5	15.5	29.63	3.38	2.50	3/4	215
15	114H15	14	1	11	15.5	29.63	3.38	2.50	3/4	365
15	116F15	16	1	8.75	17.5	32.50	3.38	3.00	7/8	265
15	116H15	16	1	13.75	17.5	32.50	3.38	3.00	7/8	505
15	118F15	18	1	8.75	19.5	34.50	3.38	3.00	7/8	305
15	118H15	18	1	12.75	19.5	34.50	3.38	3.00	7/8	605
15	210F15	10	2	7.5	11.5	25.00	3.38	1.63	9/16	120
15	212F15	12	2	7.5	11.5	26.88	3.38	2.50	5/8	185
15	212H15	12	2	10.5	13.5	26.88	3.38	2.50	5/8	285
15	214F15	14	2	7.5	15.5	27.06	3.38	2.50	3/4	220
15	214H15	14	2	11	15.5	27.06	3.38	2.50	3/4	380
15	216F15	16	2	8.75	17.5	32.50	3.38	3.00	7/8	315
15	216H15	16	2	13.75	17.5	32.50	3.38	3.00	7/8	555
15	310F15	10	3	7.5	11.5	22.00	3.38	1.63	9/16	125
15	310H15	10	3	11	11.5	22.00	3.38	1.63	9/16	195
15	312F15	12	3	9.75	13.5	27.06	3.38	2.50	5/8	220
15	312H15	12	3	12.75	13.5	27.06	3.38	2.50	5/8	320
15	314F15	14	3	9.75	15.5	29.50	3.38	2.50	3/4	255
15	314H15	14	3	13	15.5	29.50	3.38	2.50	3/4	415

20 TON

WLL* Tons	Model Number	SHEAVE DIA. (in.)	# OF SHEAVES	THICKNESS (in.)	WIDTH (in.)	NET LENGTH (in.)	THROAT OPENING (in.)	SHEAVE PIN DIA. (in.)	STD WIRE ROPE DIA. (in.)	Weight Lbs.
20	114F20	14	1	7.5	15.5	29.50	3.38	2.50	3/4	215
20	114H20	14	1	11	15.5	29.50	3.38	2.50	3/4	365
20	116F20	16	1	8.75	17.5	32.69	3.00	3.00	7/8	265
20	116H20	16	1	13.75	17.5	32.69	3.00	3.00	7/8	505
20	118F20	18	1	8.75	19.5	34.25	3.00	3.00	7/8	305
20	118H20	18	1	12.75	19.5	34.25	3.00	3.00	7/8	605
20	214F20	14	2	7.5	15.5	29.50	3.00	2.50	3/4	220
20	214H20	14	2	11	15.5	29.50	3.00	2.50	3/4	380
20	216F20	16	2	8.75	17.5	32.69	3.00	3.00	7/8	315
20	216H20	16	2	13.75	17.5	32.69	3.00	3.00	7/8	555
20	218F20	18	2	8.75	19.5	34.25	3.00	3.00	7/8	340
20	218H20	18	2	12.75	19.5	34.25	3.00	3.00	7/8	640
20	312F20	12	3	9.75	13.5	27.06	3.00	2.50	5/8	220
20	312H20	12	3	12.75	13.5	27.06	3.00	2.50	5/8	320
20	314F20	14	3	9.75	15.5	29.50	3.00	2.50	3/4	255
20	314H20	14	3	13.25	15.5	29.50	3.00	2.50	3/4	415

HEAVY DUTY SHEAVES- CAST, FORMED AND WELDED



Miller Heavy Duty Sheaves are available in **cast alloy steel or formed and fabricated carbon steel.**

Miller Hi-Lift Blocks are furnished standard with cast alloy steel sheaves.

Cast alloy steel sheaves are available in standard sizes from 8" to 36" in diameter and are listed in the succeeding table.

Cast sheaves weighing up to 4 tons and to 120" diameter are available to your requirements. **Roll-formed sheaves** are produced to your requirements up to 130" in diameter. See the sheave request for quotation form in this section and

specify cast or formed, or include your drawing.

All sheaves can be manufactured to accommodate special requirements (e.g., API, ABS).

Heavy Duty Cast Sheaves

Miller Hi-Lift Blocks are furnished standard with cast alloy steel sheaves of Miller's unique design. Wire rope grooves in Miller cast sheaves are precision machined at a 30° included angle and for the specific wire rope size maximizing wire rope life.

Miller cast alloy steel sheaves are available from 8" to 36" outside diameter as follows:

1. With tapered (24" and larger) or cylindrical roller (20" and smaller) bearings
2. With SAE 660 bronze bushings
3. Finish-bored without bushing or bearing
4. Stainless steel casting in any of the above three configurations (please inquire)

When ordering sheaves, please specify outside diameter, rope size, and configuration.

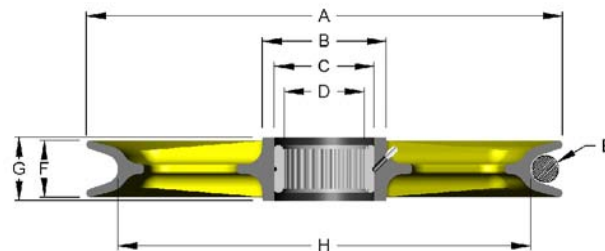

SIZE (in.)	Rope Size	A	B	C	D	F	G	H	Weight Lbs.
8	7/16, 1/2	8.00	3	2.19	1.63	1.13	1.25	6.63	7
10	1/2, 9/16	10.00	3	2.19	1.63	1.13	1.25	8.5	10.25
12	1/2, 9/16, 5/8	12.00	4	3.25	2.50	1.44	2.00	10.13	21
14	1/2, 9/16, 5/8, 3/4	14.00	4	3.25	2.50	1.75	2.00	11.63	24
16	9/16, 5/8, 3/4	16.00	5.25	3.75	3.00	2	2.38	13.25	31
18	3/4, 7/8, 1	18.00	4.63	3.75	3.00	2.125	2.38	15.5	41
18BP	5/8, 3/4, 7/8, 1	18BP	5.25	4.25	3.25	1.88	2.00	15.75	41
20	3/4, 7/8, 1, 1-1/8	20.00	5.25	4.5	3.50	2.14	2.50	17.25	48
20	3/4, 7/8, 1, 1-1/8	20.00	5.25	4.25	3.25	2.14	2.50	17.25	48
24	7/8, 1, 1-1/8	24.00	7.38	6	3.50	2.75	3.56	20.88	83
30	1-3/8, 1-1/2	30.00	8	7.19	5.00	3	3.63	25.63	152
36	1-3/8, 1-1/2	36.00	10	7.19	5.00	3	3.63	31.63	230

- For 24" sheaves please specify hub width and bore; for 20" sheaves specify shaft size



HEAVY DUTY SHEAVES- CAST, FORMED AND WELDED

Custom Sheaves

Miller has been providing **custom sheave solutions** for many years to a variety of industries including; marine, energy, construction and heavy industrial. Depending on your requirements, both cast and roll-formed sheaves can be provided. Special requirements such as API, ABS or others can be accommodated. Miller has the expertise in design and analysis to help you in your design efforts.

Cast sheaves are available to 4 tons gross weight and 120 inches in diameter from most any alloy or stainless steel material FOR BOTH, WIRE ROPE AND/OR CHAIN.

Roll-formed sheaves are available up to 130 inches in diameter and are manufactured from low carbon steel plate and forged hubs.

Following are a few samples of the variety of custom sheaves recently provided by Miller. Please fill in the form on the following page, call or send us your drawing for our quotation.



HEAVY DUTY SHEAVES- CAST, FORMED AND WELDED

REQUEST FOR QUOTATION

Name _____ Company _____ Date _____

Address _____

Telephone _____ Fax _____ E-mail _____

1. Specify type & quantity: Cast _____ Roll-formed _____ Quantity _____

2. Specify dimensions:

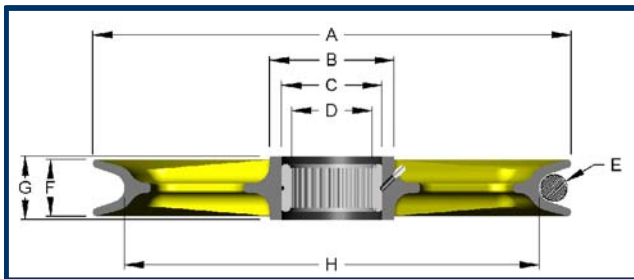

Outside diameter (A)	
Tread diameter (H)	
Shaft diameter (D)	
Rim width max (F)	
Hub O.D. (B)	
Hub Width (G)	
Hub bore dia. (C)	
Rope or chain size (E)	

3. Specific bearing type:

None, plain bore _____ Roller _____ Tapered roller _____ Composite _____ Bronze _____

4. Specify where applicable:

Base material _____ Finish _____

To industry standard _____

Special testing _____

Groove hardness _____ Third party inspection _____

Other _____

5. Fax, call or e-mail to:

Miller Products
 100A Sturbridge Rd.
 Charlton, MA 01507 USA

Tel 1.508.248.3941 / 800.733.7071
 Fax 1 .508.248.0639
 E-mail info@millerproducts.net